

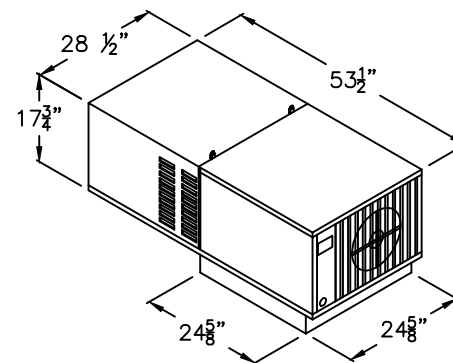

SHOWN W/ RIGHT HINGE
(LEFT HINGE AVAILABLE)

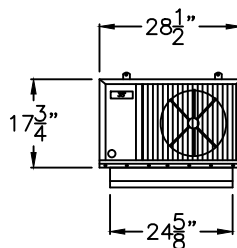

REFRIGERATION UNIT

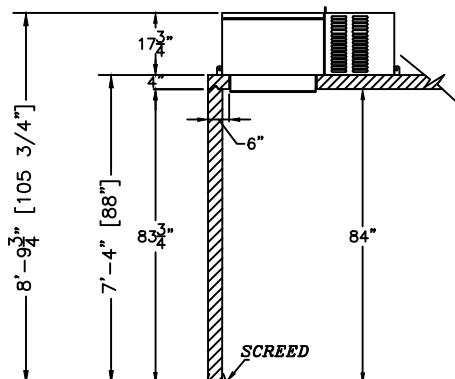

WALLS & TOP MOUNT
S/C SECTION

COOLER 35°

PRODUCT SPECIFICATIONS	
MODEL:	BL106-C
INTERIOR/EXTERIOR FINISH	MILL EMB. ACRYLUM
COMPT ELECTRICAL (VOLTS/Hz/PH)	115/60/1
COMPT AMP.	0.8 Amp
REFRIG. SYSTEM ELECT (VOLTS/Hz/PH)	208-230/60/1
REFRIG. SYSTEM AMP.	12.0 Amp
CORD + NEMA 6-20P PLUG	
REFRIG. SYSTEM WEIGHT.	195 Lbs
TOTAL SHIP WGT APPROX. (2 PALLETS)	805 Lbs
TOTAL SHIP CUBIC FEET APPROX.	201 CuFt



WALK-IN COOLERS AND FREEZERS
BY ARCTIC INDUSTRIES INC.
8731 N.W. 114th WAY MIAMI FLORIDA 33178
PHONE: (305) 883-8581

GENERAL NOTE

NOTICE TO GENERAL CONTRACTOR AND SUB-CONTRACTOR. UNIT QUARRY TILE OR CONCRETE WEARING FLOORS, THE METAL FLOORING SHALL BE SUBJECT TO STAINING DUE TO EXCESSIVE MOISTURE CREATED BY HYDRATION OF CONCRETE—TYPE 1. MATERIAL IS ESSENTIAL THAT EACH ROOM BE PROPERLY VENTILATED. SPECIAL PRECAUTIONS MUST BE TAKEN WHEN USING MASONRY ACID DUE TO EFFECTS OF ACID FUMES ON ALUMINUM AND STAINLESS STEEL. IN ADDITION, METAL SURFACES MUST BE PROTECTED FROM LIME AND OTHER CHEMICALS FOUND IN CONCRETE BY PRODUCTS. PETROLEUM BASED PROTECTION MUST BE APPLIED BETWEEN CONCRETE AND THE METAL SURFACES. (LIQUID TAR, BRUSHED OR SPRAYED ABOVE THE CONCRETE CONTACT LINE, HEAVY EPOXY PAINT, OR A THINLY APPLIED BLACK DOUBLE LAYERED, 30 LB. ASPHALT IMPREGNATED ROOFING PAPER).

CONSTRUCTION

N.S.F. CONSTRUCTION

Project Name:
ARCTIC INDUSTRIES, INC
BLUE LINE

P.O#:

APPLICATION:
MODEL: BL106-C

NOTES:

FLOOR MUST BE LEVEL SMOOTH AND CLEAR OF OBSTRUCTIONS TO ACCEPT WALK-IN PANELS. ALSO, THERE MUST BE A MINIMUM OF 2" CLEARANCE AROUND ALL SIDES OF THE WALK-IN UNIT PROPER CIRCULATION.

VERIFY ALL DIMENSIONS AND SPECIFICATIONS BEUNITE APPROVING DRAWINGS

**IMPORTANT: ALLOW 2 FEET
CLEARANCE ABOVE UNIT TO REMOVE
TOP PANEL AND TO ALLOW SERVICE
ACCESS.**

STRUCTURE MUST BE NOT MASKED
TO BUILDING CEILING, BLOCKING AIR
FLOW TO UNIT.

SIGNED APPROVED PRINT
MUST BE REC'D. B/4 FAB

☐ APPROVED AS DRAWN

SIGNED

DATE:

Drawn By:

R.PUPO

Scale:

NOT TO SCALE

DRW

DRW NO.:

BL106-C